

STEP 1

Assemble The Cement Injection TIP to its HOLDER and press firmly until making one piece

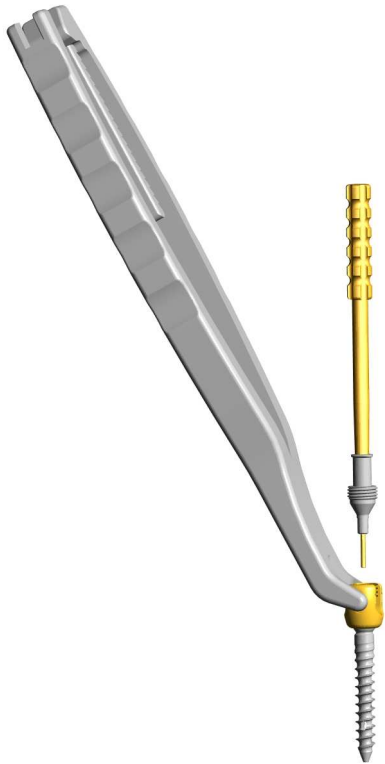

STEP 2

With the HOLDER, screw the Injection TIP into the head of the screw and tighten it Firmly. Hold the head of the screw with the Closed Rod Pusher to facilitate the screwing

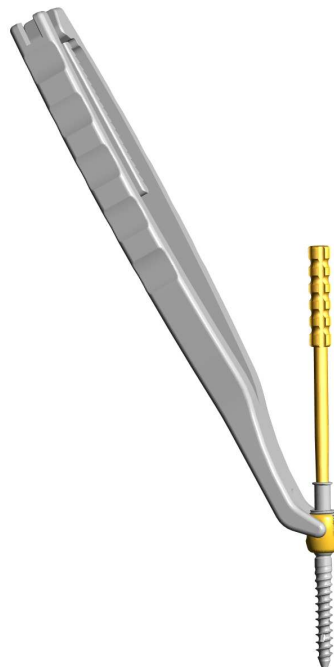

STEP 3

Remove the TIP HOLDER by turning or pulling, and continue tightening the Injection TIP with the SCREWDRIVER if necessary

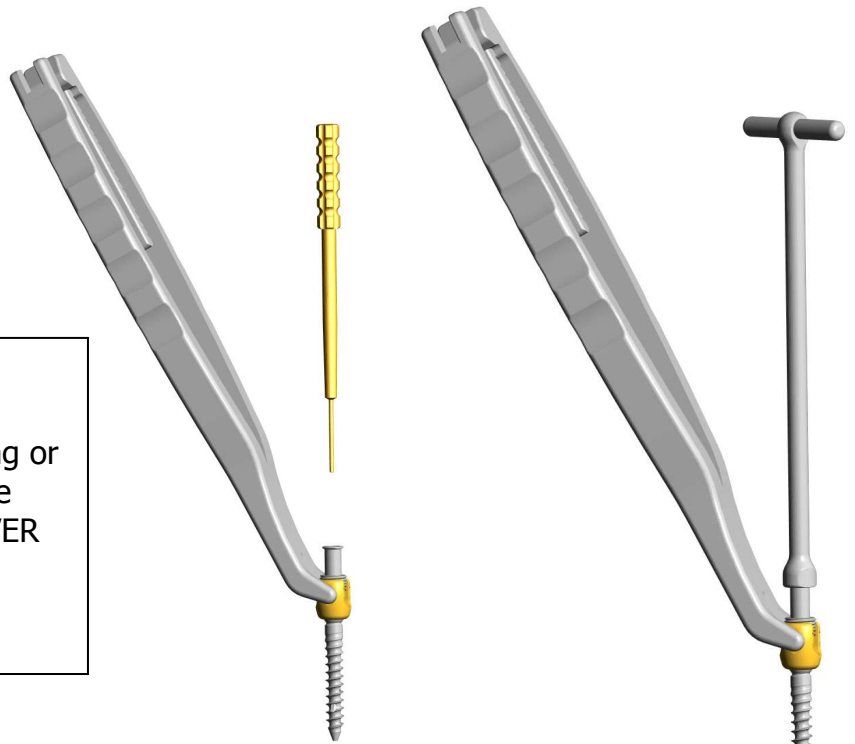

Position of the TIP after screwing in "Mouth to Mouth" to obtain optimal injection of the cement

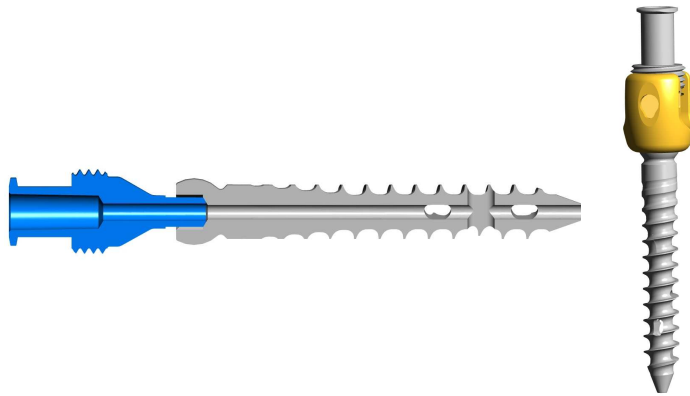

STEP 4

Mix the Cement and put it in the Syringe. It is possible to use two kind of Syringes, preferably a Luer locking Type (right picture) or a standard type with Conical End (left picture) to fit the conical part of the TIP

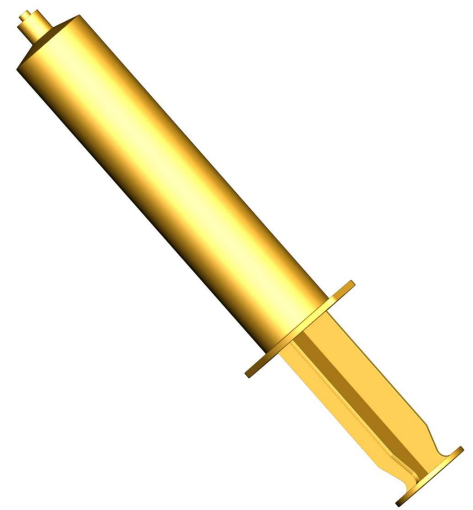

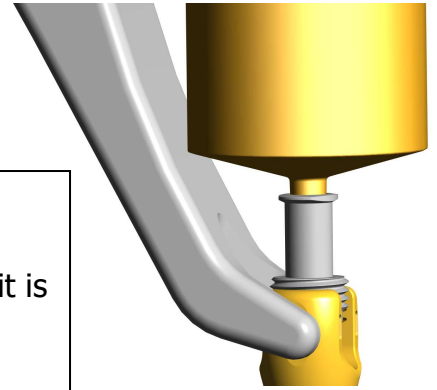
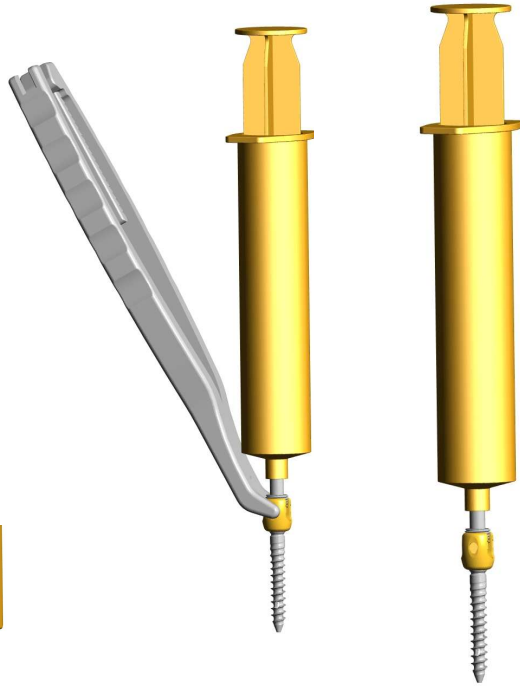
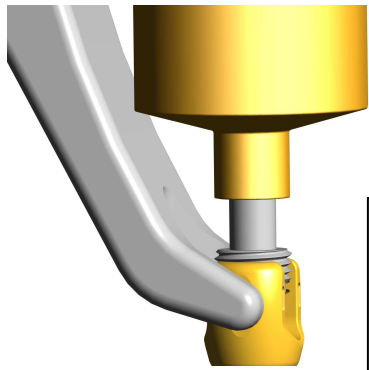

STEP 5

Screw the Syringe into the Injection TIP if it is a Luer Type (left picture) Remove the Rod Pusher and inject the cement

Or push it inside the TIP if it is a Conical End Type (right picture) Remove the Rod Pusher and inject the cement

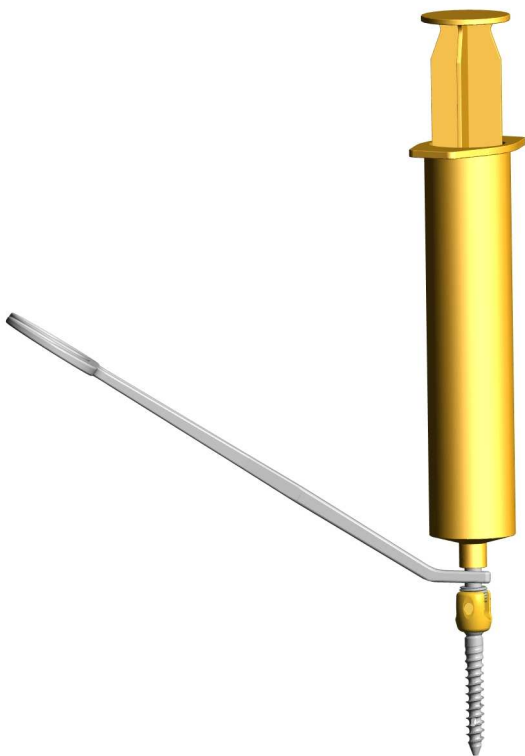

STEP 6

Hold the Injection TIP with the Transverse Bar Holder and unscrew the Syringe if it is a Luer Type, or pull it or turn it if it is a Conical End Type

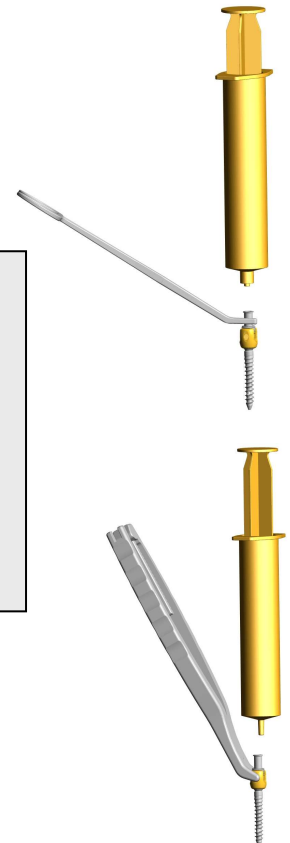

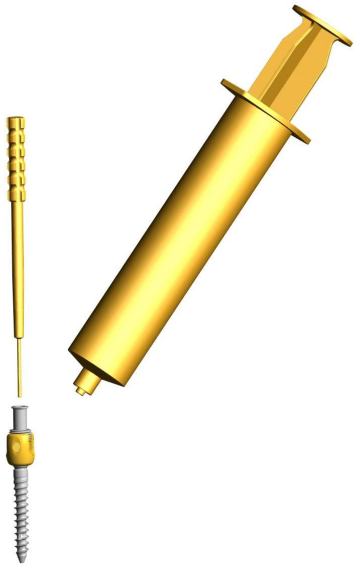

STEP 7

Insert the TIP HOLDER into the TIP and press firmly to prevent the release of the cement from the Injection TIP

Keep the HOLDER in place until the hardening of the cement



STEP 8

After the hardening of the cement remove the TIP HOLDER and make the fusion procedure by using rods and locking screws



NovaSpine

335, rue Saint Fuscien
80090 AMIENS
France

Tel : ++33.322500731

Fax : ++33.322463435

E-mail : novaspinetec@aol.com